

**Software Enhancement Modules (SEMs)** unlock advanced features within CyberAudit® software that provide specific functionality. Each SEM can be purchased individually, enabling CyberAudit customers to pay for only the features they need. Available SEMs include:

### Enterprise Location Graphics Module (CAW-M01)

The Location Graphics module opens a visual interface tool that allows CyberLocks and Communicators to be graphically “placed” on drawings, pictures, or maps (JPEG, PNG, or TIFF compatible). In particular, this module helps large and geographically spread-out CyberLock deployments to improve tracking and locating of locks and communicators.

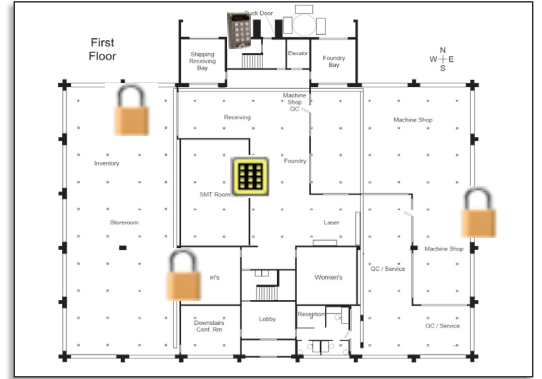

### Professional Door & I/O Support Module (CAP-M01)

### Enterprise Door & I/O Support Module (CAW-M02)

The Door & I/O software module adds software features required to manage all the functionality the Door & I/O hardware module brings to a Flex System installation. In addition to managing individual access rights to each door, Request-to-Exit (RTE) events are recorded, doors can be set to automatically unlock and relock at specified times, door sensors are monitored, and alarms can be triggered if a door is forced or left open after a specified amount of time.

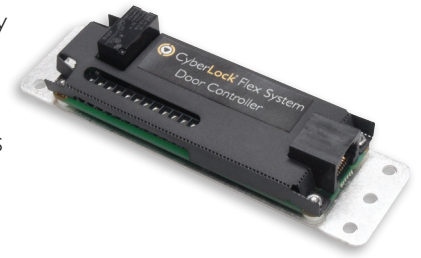

### Enterprise Key Security Enhancement Pack Module (CAW-M03)

The Key Security Enhancement Pack includes three security features. The first is an option that makes the first key of a multi-key operation the sole key able to open a CyberLock within an eight-second window. The second adds a Temporary Activation option that enables activating an expired CyberKey® for five minutes by touching a selected CyberLock or CyberPoint®. The third feature provides an option to limit Temporary Activation and One-Time Use settings to an 8-second window.



### Enterprise Lock List Filtering (CAW-M04)

The Lock List Filtering module enables limiting the number of locks loaded into CyberKeys on a per communicator basis. This is needed when CyberKeys require individual permission to more than the maximum 3300 locks they can now hold. With this enhancement, keys and missions may be granted access to an overall unlimited number of individual CyberLocks and each communicator in the system filters the locks to selected tags.

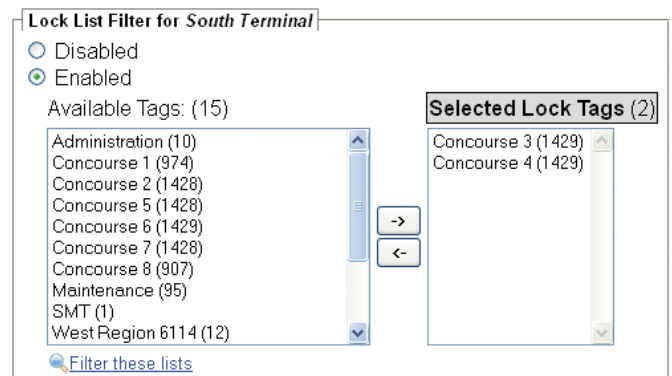

### Enterprise LDAP Authentication (CAW-M05)

The LDAP Authentication module enables basic LDAP authentication for selected administrator logins. When enabled, CyberAudit can optionally validate the administrator's login and password against the LDAP server rather than from within CyberAudit. CyberAudit supports the LDAPS method of sending the user name and password to the LDAP server via SSL on port 636. It does not support proxies or port forwarding to establish the LDAP connection.

LDAP Server	<input type="text" value="10.0.203.177"/>
DN	<input type="text" value="ldap.enterprise.com"/>
Login	<input type="text" value="danielb"/>
	<input type="checkbox"/> Suspend Login
	<input checked="" type="checkbox"/> Use LDAP to Validate Password

For more information about the SEM feature packs, please contact CyberLock, Inc. Sales at 541-738-5500 or [sales@cyberlock.com](mailto:sales@cyberlock.com).

#### CyberLock, Inc.

1105 N.E. Circle Blvd., Corvallis, OR 97330

541-738-5500 • Fax 541-738-5501 • [www.cyberlock.com](http://www.cyberlock.com) • [sales@cyberlock.com](mailto:sales@cyberlock.com) • [support@cyberlock.com](mailto:support@cyberlock.com)

CyberLock, CyberKey, CyberPoint, and CyberAudit are registered trademarks of Videx, Inc. GCO3367